

SPEAK2TV OVERVIEW

Tap the screen or click your remote for your community features on the right side of the screen.



Greeting

Let everyone know you are up and started your day.



Orders

Create a request for services.



Meals

See your meals or place an order for delivery.



Survey Question

Answer your communities survey questions.



Calendar

View and register for your community events.



Profile

Update your personal details, news scroll, and greeting message.



ORDERS



Place an Order

To place an order, click on the orders icon on your screen. This will present the available services in your community.

Select the Category and Service of your order.

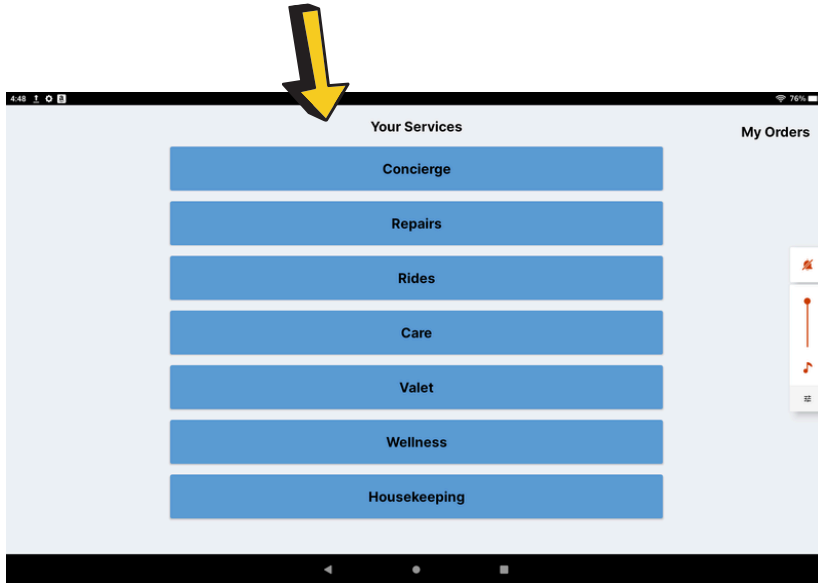

Tap this button to enable speech entry.



Fill in your details. NOTE: you can press the Alexa button on your remote to speak your details into the form.

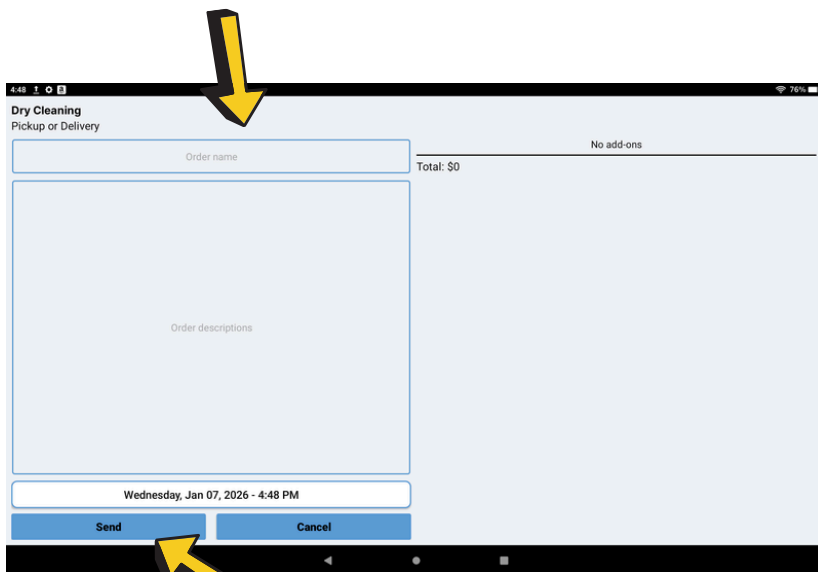

Click send when you are ready.

FEATURES

View the calendar. Click any event to see the details.

Calendar



View your meals and order button (if available).

Menu

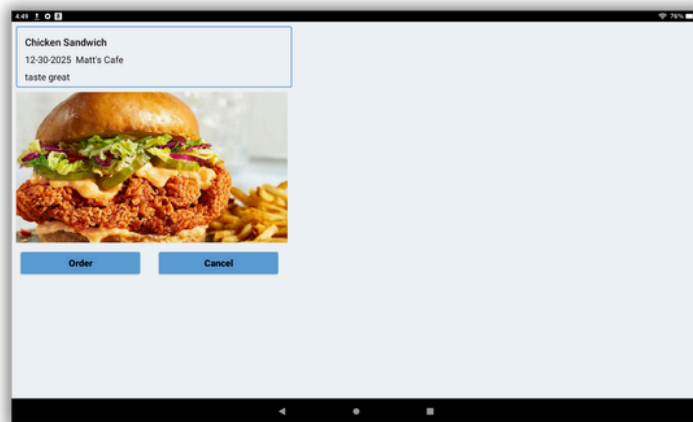

Answer your survey question.

Survey

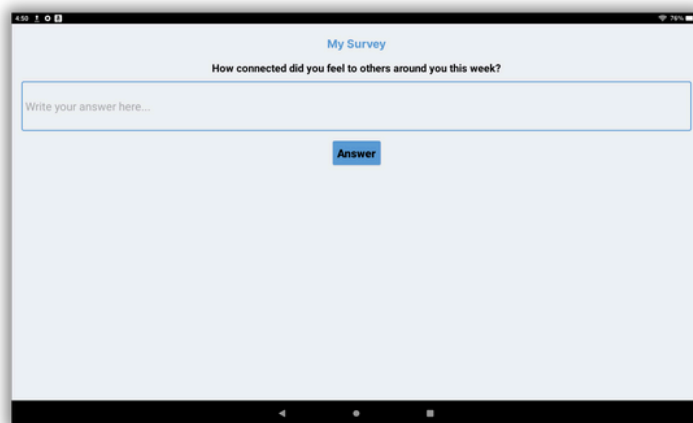

PROFILE & GREETING

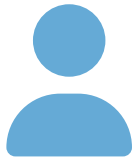

Profile

In your profile you can edit your personal information, edit the way in which the TV app works, and update your Greeting to friends and family.



Greeting

When you press the Greeting button on your home screen, it sends a notification to your community and enabled contacts. You can customize the message sent.

You can select one of the pre-defined greetings.

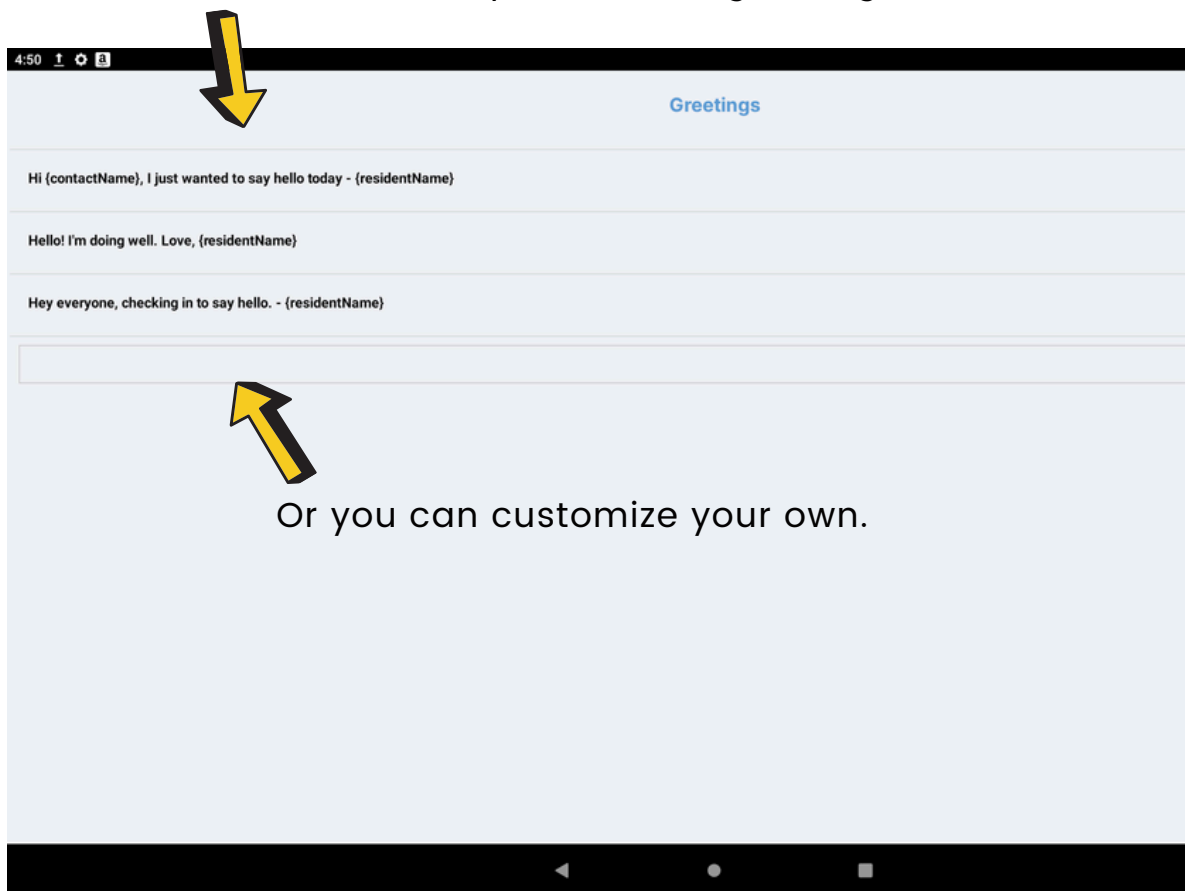

Or you can customize your own.